

# PIR data sheet

## Parameter

Model No.	K6
Fuction discription	Embedded tube type, load control relay
Operating voltage	DC 12V
Perating temp.	-20 °C ~ +50 °C
Load capacity	All kinds of lighting, all kinds of electrical
Connecting style	Bipolar
Output mode	induction output
Light control range	5 Lux ~ 500Lux ± 20% (adjustable)
Delay shutdown time	16~350 Secs ± 30% (adjustable)
Induction mode	passive
Induction angle	360°coning angle
Detecting distance	10 M
Color	white
Dimension/color	100*100*35 mm



1. Automatic induction: when people enter into the range of induction, it will turn on, when people leave, it will turn off with delay.
2. It can be applied to corridor ,passageway, toilet, basement, warehouse, garage, etc., which have the function of automatic lighting, and control.
3. Photosensitive control: it adopting photoactive control, it doesn't turn on during daylight or in strong light environment.
4. Automatic random delay: After it turns on, in the delay period, if there is presence of people, it keeps on working until people leave, than turn on with delay.
5. Status indicator: efficient LED indicator, which is easy for installation and fault analysis.
6. Temperature compensation: specialized temperature compensation chip, which used to reducing the effect of temp. on detecting distance.

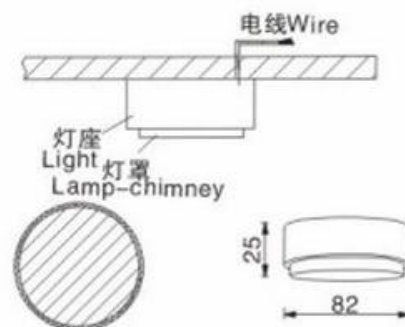
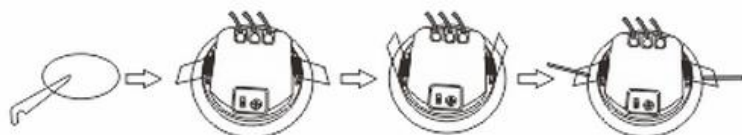

## Infrared Switch wire method with the RCU

